

■ PRODUCT CHARACTER

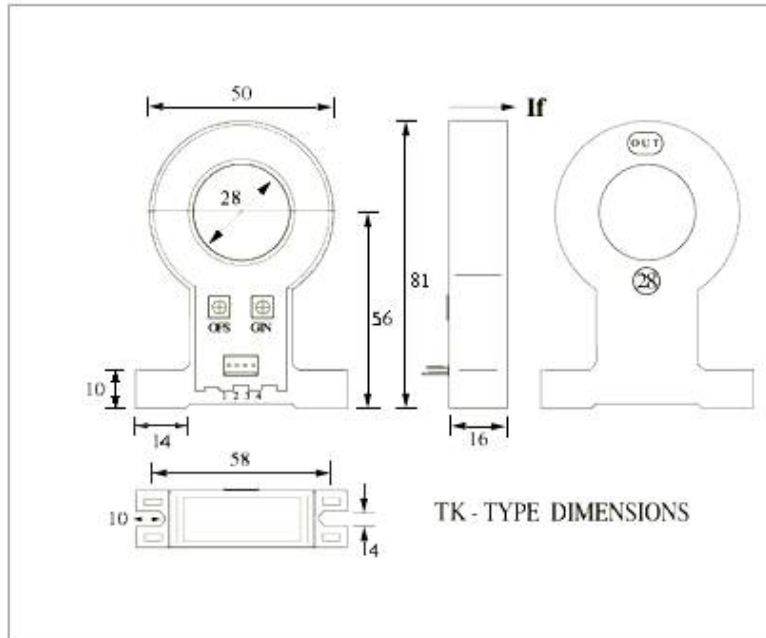

PANEL 장착용으로 미려한 디자인과 28mm 구경의 측정용 홀은 구경의 높이가 바닥에서 구경 중심까지 15mm에서 56mm로 다양한 치수를 확보하고 있으며, 넓은 적용전류범위와 우수한 품질특성을 지닌 제품.

■ DIMENSIONS



■ TK1A,TK2A-TYPE STANDARD SPEC

[Ta=25℃,RL=10KΩ]

Type-code		TK1(2)A 040	TK1(2)A 050	TK1(2)A 100	TK1(2)A 200	TK1(2)A 300	TK1(2)A 400	TK1(2)A 500	TK1(2)A 600
Parameter	Symbol								
Rated Current (F.S.)	If	040A	050A	100A	200A	300A	400A	500A	600A
Linear Range		080A	100A	200A	400A	600A	800A	930A	930A
Output Voltage	Vh	±04V±1% at If							
Zero Current Offset	Vo	Within ±20mV at If = 0							
Linearity of Output	ρ	Within ±1.0% of Vh at If : F.S.							
Supply Voltage	Vc	±12V or ±15V ±5%							
Response Time	Tr	7μsec Max. at di/dt = F.S./μsec							
Frequency Range	f	DC ~ AC10KHz and 15KHz Max.							
Output Voltage Temperature Coef.		Within ±0.1% / °C Max.							
Zero Offset Voltage Temperature Coef.		Within ±1.0mV / °C Max.							
Dielectric Strength		2.5KV AC with 60Hz × 1minute 관통부 내측-신호핀 간							
Insulation Resistance		500[MΩ]Min. at 500V DC 관통부 내측-신호핀 간							
Operating Temp.	Ta	-10 ~ +80℃							
Storage Temp.	Ts	-25 ~ +85℃							
Note		TK1A PINOUT (1)+V (2)0V (3)-V (4)OUTPUT CONNECTOR : Molex 社, 5045-04A				TK2A PINOUT (1)+V (2)-V (3)OUTPUT (4)0V CONNECTOR : Molex 社, 5045-04A			

TK1S,TK2S-TYPE STANDARD SPEC

[Ta=25℃,RL=10KΩ]

Type-code		TK1(2)S 040	TK1(2)S 050	TK1(2)S 100	TK1(2)S 150	TK1(2)S 200	TK1(2)S 300	TK1(2)S2 400
Parameter	Symbol							
Rated Current (F.S.)	If	40A	50A	100A	150A	200A	300A	400A
Linear Range		80A	100A	200A	300A	400A	600A	800
Output Voltage	Vh	+04V±1% at If						
Zero Current Offset	Vo	NO OUTPUT +50mV at If						
Linearity of Output	ρ	Within ±1.5% of Vh at If : F.S.						
Supply Voltage	Vc	+12V or +15V ±5%						
Response Time	Tr	20μsec Max. at di/dt = F.S./μsec				20μsec Max. at di/dt = F.S./μsec		
Frequency Range	f	DC ~ AC10KHz and 15KHz Max.				DC ~ AC5KHz and 10KHz Max.		
Output Voltage Temperature Coef.		Within ±0.1% / °C Max.						
Zero Offset Voltage Temperature Coef.		Within ±1.0mV / °C Max.						
Dielectric Strength		2.5KV AC with 60Hz × 1minute 관통부 내측-신호핀 간						
Insulation Resistance		500[MΩ]Min. at 500V DC 관통부 내측-신호핀 간						
Operating Temp.	Ta	-10 ~ +80℃						
Storage Temp.	Ts	-25 ~ +85℃						
Note		TK1S PINOUT (1) +V (2) 0V (3) 0V (4) OUT Connector : Molex 5045-04A				TK2S PINOUT (1) +V (2) 0V (3) OUT (4) 0V Connector : Molex 5045-04A		

TK1D,TK2D-TYPE STANDARD SPEC

[Ta=25℃,RL=10KΩ]

Type-code		TK1(2)D 040	TK1(2)D 050-15	TK1(2)D 100	TK1(2)D 200	TK1(2)D 300	TK1(2)D 400
Parameter	Symbol						
Rated Current (F.S.)	If	040A	050A	100A	200A	300A	400A
Linear Range		060A	075A	150A	350A	450A	600A
Output Voltage	Vh	±04V±1% at If					
Absolute Output Voltage	Vab	ab04V±1% at Vh					
Zero Current Offset	Vo	Within ±20mV at If = 0					
Linearity of Output	ρ	Within ±1.0% of Vh at If : F.S.					
Supply Voltage	Vc	±12V or ±15V ±5%					
Vh - Response Time	Tr	7μsec Max. at di/dt = F.S./μsec					
Vab - Response Time		25μsec Max. at di/dt = F.S./μsec and non capacity					
Frequency Range	f	DC ~ AC5KHz and 25KHz Max.					
Output Voltage Temperature Coef.		Within ±0.1% / °C Max.					
Zero Offset Voltage Temperature Coef.		Within ±1.0mV / °C Max.					
Dielectric Strength		2.5KV AC with 60Hz × 1minute 관통부 내측-신호핀 간					
Insulation Resistance		500[MΩ]Min. at 500V DC 관통부 내측-신호핀 간					
Operating Temp.	Ta	-10 ~ +80℃					
Storage Temp.	Ts	-25 ~ +85℃					
Note		TK1D PINOUT (1)+V (2)0V (3)-V (4)A'-OUT (5)'D'-OUT CONNECTOR : Molex 社, 5045-05A			TK2D PINOUT (1)+V (2)-V (3)'A'-OUT (4)0V (5)'D'-OUT CONNECTOR : Molex 社, 5045-05A		